

**STANDARD FEATURES:**

1. 22 GAUGE GALVANIZED STEEL CASING CONSTRUCTION
2. 1/2" DUAL DENSITY LINING
3. ROUND INLET COMPATIBLE WITH NOMINAL RIGID AND FLEX DUCT CONNECTIONS
4. SLIP AND DRIVE DISCHARGE CONNECTION
5. PATENTED FLO-CROSS MULTIPOINT FLO SENSOR
6. DAMPER SHAFT WITH DELRIN BEARINGS AND POSITION INDICATOR
7. LOW LEAKAGE DAMPER WITH SEAL
8. INTEGRAL ATTENUATOR
9. RIGHT OR LEFT HAND CONFIGURATIONS AVAILABLE (LEFT HAND SHOWN)

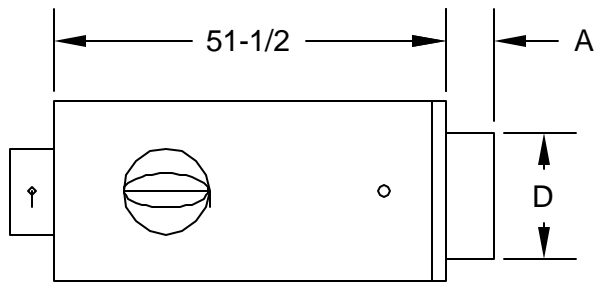

LEFT HAND SIDE VIEW

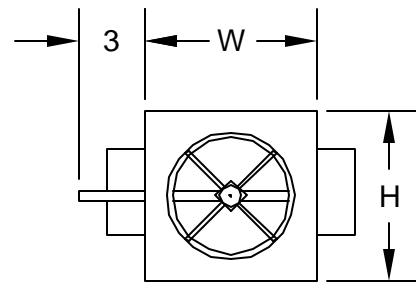

END VIEW INLET

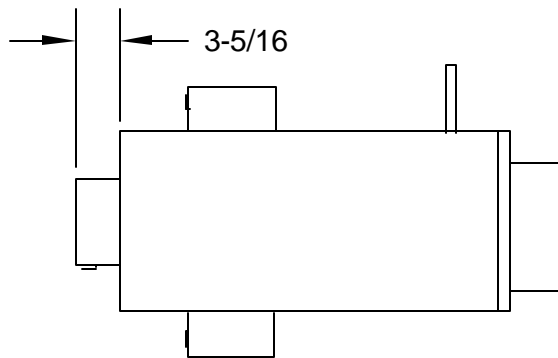

LEFT HAND BOTTOM VIEW

**OPTIONAL OUTLET CONFIGURATIONS**

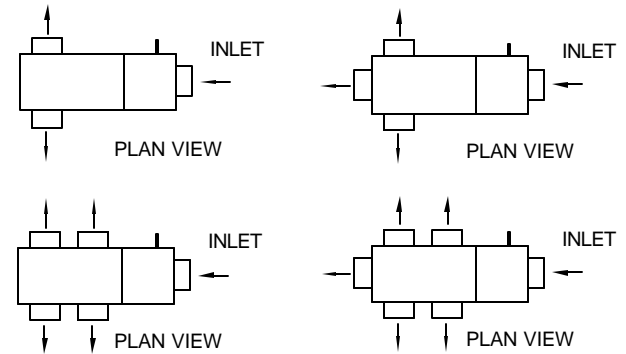

UNIT SIZE	CFM RANGE MIN TO MAX	H	W	A	D
4	0/45 - 230	8	12	5 3/8	3 7/8
5	0/70 - 360	8	12	5 3/8	4 7/8
6	0/100 - 520	8	12	3 3/8	5 7/8
7	0/140 - 710	10	12	3 3/8	6 7/8
8	0/185 - 925	10	12	3 3/8	7 7/8
10	0/290 - 1450	12 1/2	14	3 3/8	9 7/8
12	0/420 - 2100	15	16	3 3/8	11 7/8
14	0/580 - 2900	17 1/2	20	3 3/8	13 7/8
16	0/740 - 3700	18	24	3 3/8	15 7/8

**LINER OPTIONS:**

- 1/2" DUAL DENSITY
- 1" DUAL DENSITY
- ENVIROSEAL
- INSULGUARD
- NO LINER

SEE SUBMITTAL SD-7005 FOR LINER PROPERTIES

**CONSTRUCTION:**

- 20 GAUGE
- ACCESS DOOR
- CAM LATCHES

CAM LATCHES REQUIRE AN ACCESS DOOR

**ACCESSORIES:**

- CONTROL ENCLOSURE
- DISC. SWITCH
- DUSTTIGHT SEAL
- HANGER BKT
- TRANSFORMER
  - 120V / 24V
  - 208V / 24V
  - 240V / 24V
  - 277V / 24V
  - 480V / 24V

JOB NAME: \_\_\_\_\_  
 LOCATION: \_\_\_\_\_  
 ARCHITECT: \_\_\_\_\_  
 ENGINEER: \_\_\_\_\_  
 CONTRACTOR: \_\_\_\_\_

SUBMITTED BY: \_\_\_\_\_

DATE: AUGUST '02

DRAWING NUMBER: SD-7015

**SDV - SINGLE DUCT TERMINAL UNIT**

WITH INTEGRAL MULTI-OUTLET PLENUM