

C01 - Upper Hanging Clip

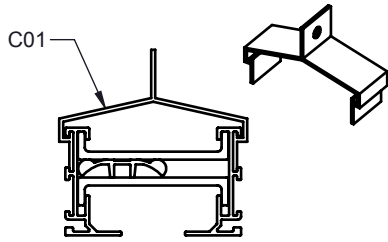

Suspends the AIR-TRAC™ assembly from the ceiling structure using standard hanger wire.

C02 - Upper Support Hanger

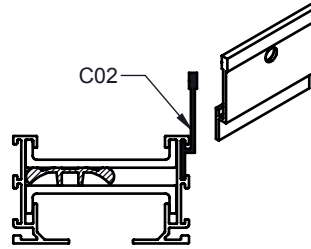

Suspends one side of the AIR-TRAC™ assembly from the ceiling structure.

C03 - Spline Clip

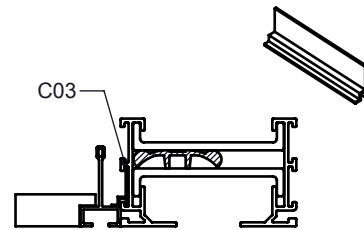

Support Margin Style L on Bolt-Slot type suspension systems.

C04 - Spline Support Clip (field formed)

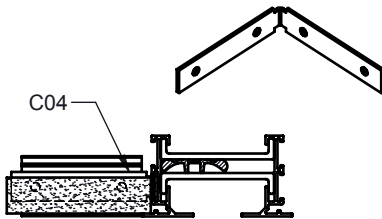

Integrates standard drop "Teas" with AIR-TRAC™ assembly.

C04 - Connector Clip (as shipped)

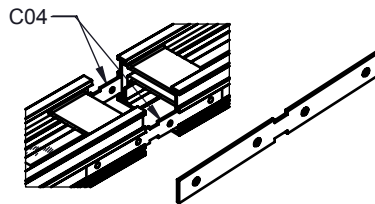

Adjoins multiple sections of AIR-TRAC™.

C05 - Hard Ceiling Clip

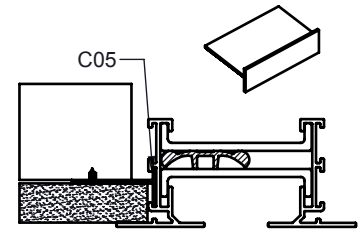

Used for mounting Margin Style B or E with standard 5/8" gypsum board.

C06 - Hard Ceiling Clip

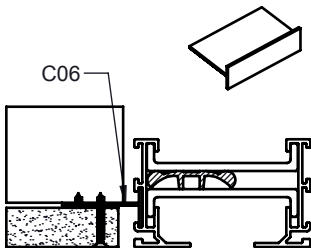

Used for mounting Margin Style L or E with standard 5/8" gypsum board.

C07 - Hard Ceiling Clip

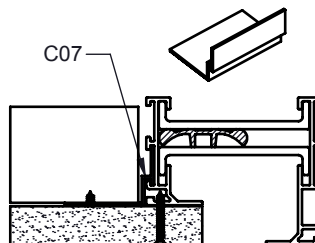

Used to mount short side of Margin Style D with standard 5/8" gypsum board.

C07 - Hard Ceiling Clip

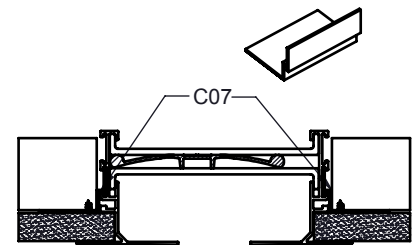

Can be used to mount Margin Style S with standard 5/8" gypsum board.

Dimensions in inches

Job: _____	Tag: _____	AIR-TRAC™ Hanger & Mounting Clips
Location: _____	Submitted By: _____	
Architect: _____		
Engineer: _____		
Contractor: _____	SD - 2097	Rev: B (1/19)

C08 - Hard Ceiling Clip

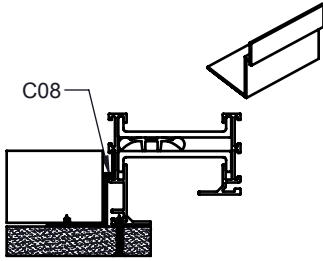

Mounts the long side of assembly with Margin Style D border for 5/8" gypsum board.

C09 - Hard Ceiling Clip

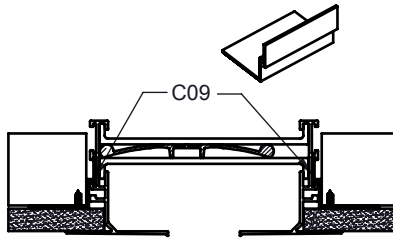

Used to mount Margin S to 1/2" gypsum board (residential).

C10 - Hard Ceiling Clip

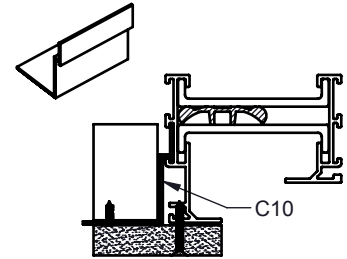

Mounts the long side of Margin D to 1/2" gypsum board (residential).

C11 - Wall Clip

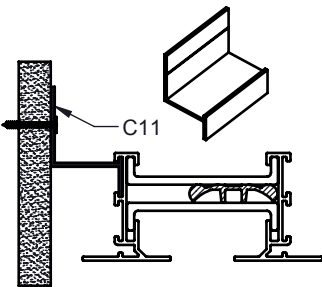

Mounts Margin Styles L, B, or E away from a wall when a reveal is required. This reveal can be used as a return air slot.

C12 - Wall Clip

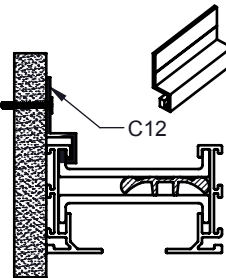

Mounts Margin Styles L or E flush to a wall.

C13 - Wall Clip

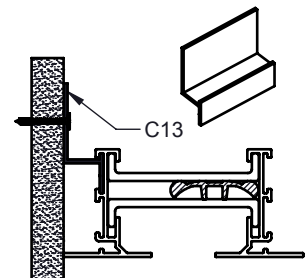

Used for flush mounting Margin Styles B or E to a wall.

Margin Style	1 Slot	2 Slot
L	C01, C02, C03, C06, C11, C12	C02, C03, C06, C11, C12
D N B,C	C01, C02, C07, C08, C10 C01, C02, C07, C08, C09 C01, C05, C11, C13	N/A N/A C02, C05, C11, C13
E	C01, C02, C03, C05, C06, C11, C12, C13	C02, C05, C11, C12, C13
S	C01, C02, C07, C08, C09	C02, C07, C08, C09

C01 is used only in slot widths 1", 1 1/2", and 2"

Dimensions in inches

Job: _____	Tag: _____	AIR-TRAC™ Hanger & Mounting Clips
Location: _____	Submitted By: _____	
Architect: _____		
Engineer: _____		
Contractor: _____	SD - 2097 Rev: B (1/19)	