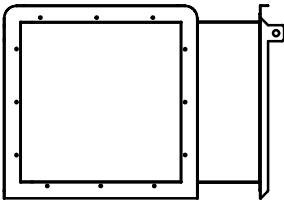

- 304 stainless steel construction (316 SS and aluminum optional)
- Plenum includes rounded corners for ease of cleaning
- Field installed onto V-Slot Linear Diffusers
- Standard finish is satin polish (SP) for stainless models and white paint for aluminum
- Optional finish for stainless models is white paint (WH)

**Plenum Elbow**

Side View

**Installed View \***

Plan View

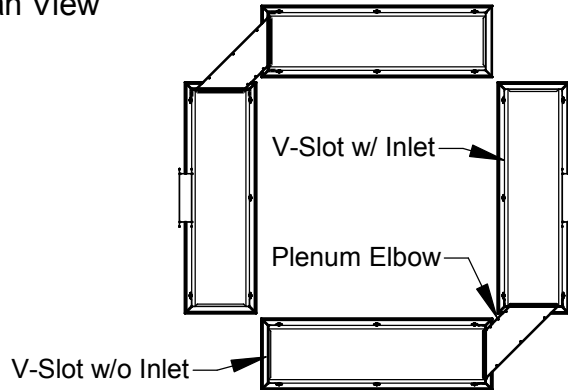
**Plenum Elbow**

Plan View

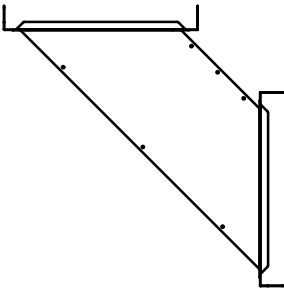
**Installed View \***

As seen from occupied space

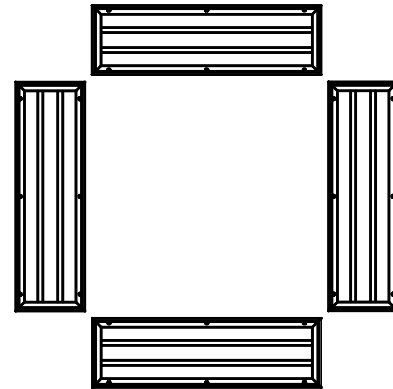
**Options**
**Construction**

 304 Stainless Steel  
 316 Stainless Steel  
 Aluminum

**Finish**

 Satin Polish  
 White Paint

\* V-Slots shown are ordered separately

 Job: \_\_\_\_\_  
 Location: \_\_\_\_\_  
 Architect: \_\_\_\_\_  
 Engineer: \_\_\_\_\_  
 Contractor: \_\_\_\_\_

Submitted By: \_\_\_\_\_

**V-Slot Plenum Elbow**  
**For use with V-Slot Diffusers**

SD-1881

Rev: B (08/04)