

- Constructed of 22 Ga. galvanized steel
- 1/2" thick dual density fiberglass insulation meets requirements NFPA 90A and UL181
- Field adjustable fan speed control
- Backdraft damper
- Easy access to internal components for maintenance via removable bottom panel
- Flo-cross sensor averages readings across all four quadrants of inlet
- 24 volt control transformer for electronic controls
- Induced air inlet attenuator
- **ETL** listed; **AHRI** certified sound ratings

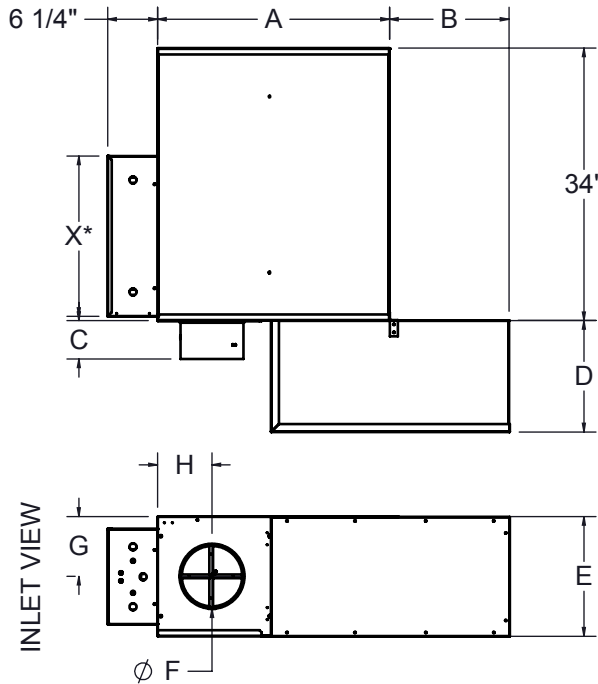

Options:

- 20 Ga. galvanized steel construction
- PSC Motor (Standard)
 - 120 V 208V/240V 277V
- Optional Liners
 - 1" dual density fiberglass insulation
 - 1/2" Enviroseal
 - 1" Enviroseal
 - 1" Insulguard
- Dust tight control enclosure
- Hangar brackets
- Motor disconnect
- Motor fusing
- Filter

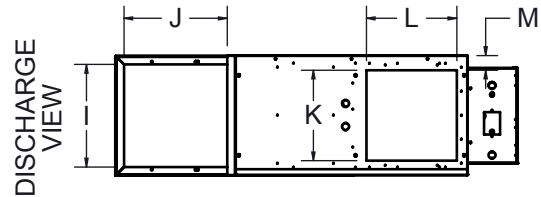

* Note: Digital or Analog control enclosure is 20" x 11 7/8",
Pneumatic enclosure is 17" x 15"

| UNIT SIZE | INLET SIZE | HP | A | B | C | D | E | F | G | H | INDUCED | | DISCHARGE | | M |
|-----------|------------|------|----|----|-------|----|--------|--------|-------|-------|---------|--------|-----------|--------|-------|
| | | | | | | | | | | | I | J | K | L | |
| 2 | 06 | 1/10 | 29 | 15 | 4 7/8 | 15 | 15 | 5 7/8 | 7 1/2 | 6 7/8 | 13 | 13 | 11 1/2 | 11 1/2 | 1 3/4 |
| 2 | 08 | 1/10 | 29 | 15 | 4 7/8 | 15 | 15 | 7 7/8 | 7 1/2 | 6 7/8 | 13 | 13 | 11 1/2 | 11 1/2 | 1 3/4 |
| 3 | 08 | 1/10 | 29 | 15 | 4 7/8 | 15 | 15 | 7 7/8 | 7 1/2 | 6 7/8 | 13 | 13 | 11 1/2 | 11 1/2 | 1 3/4 |
| 3 | 10 | 1/10 | 29 | 15 | 4 7/8 | 15 | 15 | 9 7/8 | 7 1/2 | 6 7/8 | 13 | 13 | 11 1/2 | 11 1/2 | 1 3/4 |
| 4 | 10 | 1/4 | 29 | 15 | 4 7/8 | 15 | 15 | 9 7/8 | 7 1/2 | 6 7/8 | 13 | 13 | 11 1/2 | 11 1/2 | 1 3/4 |
| 4 | 12 | 1/4 | 29 | 15 | 6 7/8 | 15 | 15 | 11 7/8 | 7 1/2 | 6 7/8 | 13 | 13 | 11 1/2 | 11 1/2 | 1 3/4 |
| 5 | 12 | 1/2 | 37 | 19 | 6 7/8 | 19 | 17 3/4 | 11 7/8 | 8 7/8 | 9 | 17 | 15 3/4 | 14 | 15 1/2 | 1 7/8 |
| 5 | 14 | 1/2 | 37 | 19 | 6 7/8 | 19 | 17 3/4 | 13 7/8 | 8 7/8 | 9 | 17 | 15 3/4 | 14 | 15 1/2 | 1 7/8 |
| 6 | 14 | 1/2 | 37 | 19 | 6 7/8 | 19 | 17 3/4 | 13 7/8 | 8 7/8 | 9 | 17 | 15 3/4 | 14 | 15 1/2 | 1 7/8 |
| 6 | 16 | 1/2 | 37 | 19 | 6 7/8 | 19 | 17 3/4 | 15 7/8 | 8 7/8 | 9 | 17 | 15 3/4 | 14 | 15 1/2 | 1 7/8 |
| 7 | 16 | 3/4 | 37 | 19 | 6 7/8 | 19 | 17 3/4 | 15 7/8 | 8 7/8 | 9 | 17 | 15 3/4 | 14 | 15 1/2 | 1 7/8 |

Dimensions in inches

| | | |
|-------------------|---------------------|---|
| Job: _____ | Tag: _____ | FPP Fan-Powered Terminal Unit Parallel or Variable |
| Location: _____ | Submitted By: _____ | |
| Architect: _____ | | |
| Engineer: _____ | | |
| Contractor: _____ | SD - 2189 | Rev: B (03/17) |